

# URANO BT



Electromechanical automation system for rack sliding gates weighing up to 1200 kg, for apartment-block and industrial applications



Maximum safety with anticrushing device

Easily accessible control panel

Adjustable slowdown in both travel directions

Diagnostics and statistics shown on display panel

Reverse function in case of obstacles





# URANO BT



Electromechanical automation system for rack sliding gates weighing up to 1200 kg, for apartment-block and industrial use

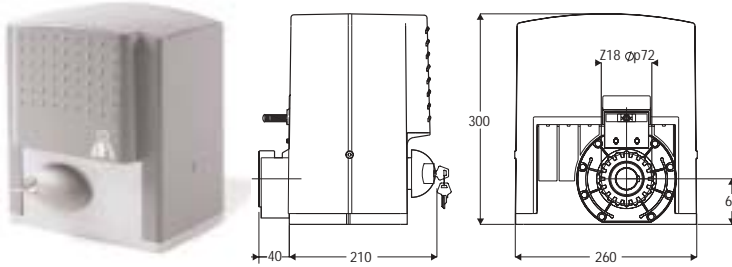

- Maximum performance and continuous service offered by URANO BT irreversible gearmotor.
- Emergency manual operation possible thanks to an ergonomic handle with personalised key.
- Maximum safety against crushing thanks to the adjustable electronic torque limiter.
- Diagnostic and statistical functions through the display.
- Rolling code receiver and 64 codes inside the control board.
- Design and practicality: great aesthetic innovation and improved guard solidity.
- Control panel prearranged for the EELink protocol.
- Travel stop controlled by electromechanical micro-switches.
- Immediate reversal in case of impact.
- In case of power supply failure, operation is guaranteed by a back up battery unit (BT BAT 2) inside the motor casing. Supplied upon request.
- Available in the inductive limit switch version (by using the FCM KIT).

## Technical specifications

Operator	URANO BT
Power supply	230 V ± 10%, 50 Hz single-phase
Motor	24 Vdc
Absorbed power	80 W
Max. leaf weight	12000 N (~1200 kg)
Output revolutions	39 min <sup>-1</sup>
Pinion pitch	4mm (18 teeth)
Leaf speed	9 m/min
Impact reaction	electronic torque limiter
Manual manoeuvre	mechanical knob release with personalised key
No. manoeuvres in 24 hours	120
Control panel	QSC D MA
Type of limit switch	electromechanical or inductive
Environmental conditions	from -15° to +60°C
Degree of protection	IP 24
Operator weight	200 N (~20 kg)
Dimensions	see drawing

## Example of installation

M gearmotor URANO BT with built-in control board QSC D MA and rolling code receiver  
 T double-channel rolling code transmitter, MITTO 2 12V  
 Fte-Fre pair of photocells, CELLULA 130  
 Fti-Fri pair of photocells, CELLULA 50

CF pair of photocell posts, CC50  
 AL blinker LAMPO AI 24V with integrated antenna  
 S key selector, INTRO  
 CS safety edge  
 C galvanised iron rack, CFZ

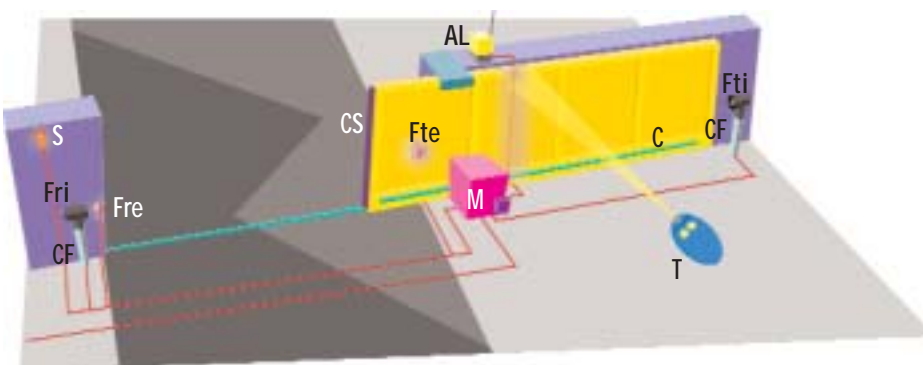

## Accessories



MITTO 2-12V / MITTO 4-12V: double-channel 12V and four-channel transmitter with Rolling-Code coding.



CFZ: 22x22 galvanised iron 4-pitch rack, 2mts length in 10m packs.



CVZ -S: 30x8 4-pitch drilled galvanised iron rack with support. 1mt length in 10m packs.



CVZ: 30x12 galvanised iron 4-pitch rack, drilled with support. 1mt length in 10m packs.



BT BAT 2: The BT BAT 2 device ensures, through its back up batteries and battery charger, low-voltage operation of the sliding gate when there is no power supply. (For URANO BT)



CSP 25: Shock absorber profile, length 2500 mm.

KIT FCM: Magnetic limit switch kit for sliding gates, applicable to all versions of the URANO BT model featuring a rack-and-pinion drive. Suitable for snowy areas or subject to icing.

## QSC D MA

The following are the functions of the newly conceived QSC D MA control unit with integrated clonix receiver:  
 LCD display, 3- or 4-step functional logic, pedestrian opening, door open LED, second radio channel, photocells excluded during opening, remote auto-learning, pulse blocking during opening, automatic opening time, torque limiter can be set differently for opening and closing, slowdown during opening and closing, hold-to-run control, pre-alarm.

For system composition and installation refer to the regulations in force in the country where the system is being installed. The indicated data are not binding. BFT reserves the right to make modifications without prior notice.